

## 20L Backpack Sprayer 20L\_BPS



**INSTRUCTION MANUAL**

## 20L Backpack Sprayer 20L\_BPS

The Jono & Johno 20L\_BPS backpack hand operated sprayer is a new generation of all plastic backpack hand operated sprayer developed by Jono and Johno. High efficient and leak proof, it is perfect for areas such as houses, public places and cattle pens.

The sprayer is made of pure high quality materials and is built to last.

The sprayer is modelled with an arcing shape so that it fits nicely to the operators back and doesn't cause any strain while the operator is using the device. Even after hours of use, this unique "T" shape design helps ease the feeling of heaviness.

It comes with a safety valve on the lid to ensure that no leakage of potential harmful chemicals can happen. There is also a sealing washer at the top of the air compartment to allow the pump to move easily and also guarantees that there is no leakage. There is also a water level indication to be able to easily see how much water is left in the sprayer.

The wand is made of high quality steel which can be set left or right by the operator. It is also able to attach to the side of the sprayer in an upright position which allows easy storage.

## 20L Backpack Sprayer 20L\_BPS

### Installation and Usage

1. Open the lid of the sprayer (do not remove the filler screen) and pour in your desired liquid.
2. Put sprayer onto your back and adjust to a comfortable position using the adjustable straps.
3. Press the pressure handles several times until enough pressure builds up to allow spraying.
4. Select your nozzle type. There are several different modes. Fan, mist and jet.
5. The handle can be used either left or right. It comes preinstalled for right handed operators. To switch to left some assembly is required.

### Maintenance

1. After each use, clean with warm soapy water.
2. Lubricate all parts regularly.
3. When nozzle has a blockage, use warm soapy water and spray to clear the blockage
4. Wash the filter screen regularly.

## 20L Backpack Sprayer 20L\_BPS

### Technical Parameters

1. Net Weight	3.4kg
2. Gross Weight	15.4kg
3. Package Dimensions	72x37x53cm
4. Air Compartment Capacity	0.90 L
5. Max Pressure	1.0MPa
6. Wand Length	70cm
7. Hose Length	120cm
8. Carrying Strap	100cm x 4cm x 2cm
9. Tank Capacity	20L

### Five. Container List

Number	Name	Unit	Quantity
1	Spray mainEngine	Set	1
2	Instruction	Copy	1
3	Fan-shape Nozzle Assembly	Set	1
4	Sealing washer	Piece	3
5	Cup Ring	Piece	1

## 20L Backpack Sprayer 20L\_BPS

### DIAGRAM

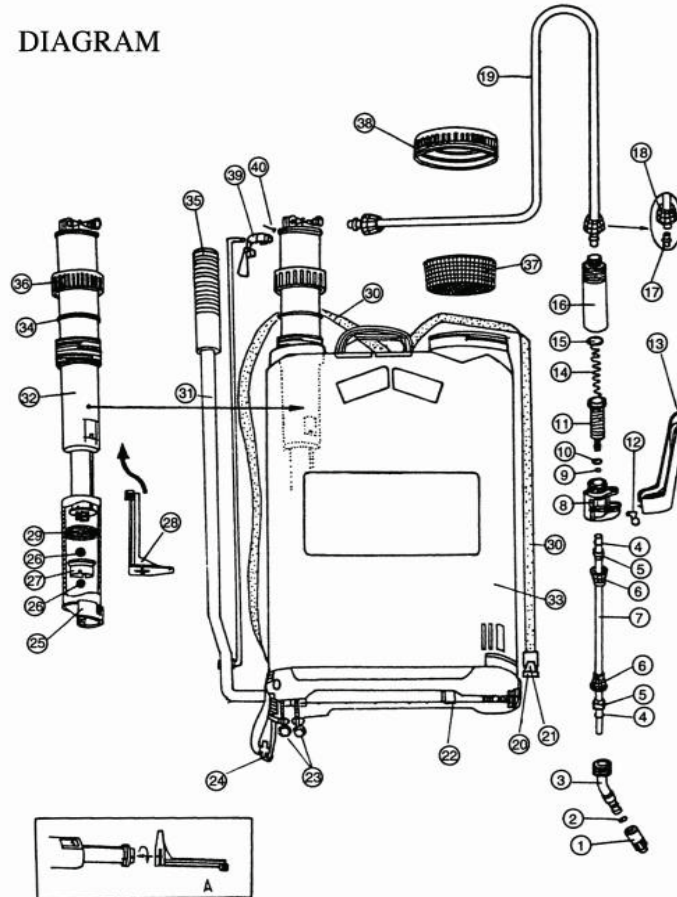

## 20L Backpack Sprayer 20L\_BPS

### Parts List

1	Adjustable Nozzle Cap
2	Adjustable Nozzle O-Ring
3	Adjustable Nozzle
4	Lance Sealing O-Ring
5	Locking Sleeve
6	Lance Connector Washer
7	Lance
8	Pump Trigger
9	Filter Screen O-Ring 1
10	Filter Screen O-Ring 2
11	Trigger Filter Screen
12	Pump Key Locker
13	Pressure Bar Switch
14	Pump Spring
15	Protecting Bush O-Ring
16	Protecting Bush Switch
17	Seal Insert
18	Hose Connector Nut
19	Pump Hose
20	Carrying Fixer

## 20L Backpack Sprayer 20L\_BPS

### Parts List

21	Carrying Strap Hook
22	Orange Circlip
23	Screw Bolt
24	Carrying Strap Fixer
25	Pump
26	Seal Ball
27	Seal Valve
28	Miller
29	Cup Ring
30	Carrying Strap
31	Rocker Rod
32	Air Compartment
33	Tank
34	Pump O-Ring
35	Rocker Bar Sleeve
36	Air Compartment Pressure Lid
37	Chemical Tank Filter Screen
38	Chemical Tank Lid
39	Rocker Bar Mount
40	Split Pin

## 20L Backpack Sprayer 20L\_BPS

### Orange Circlip Installation

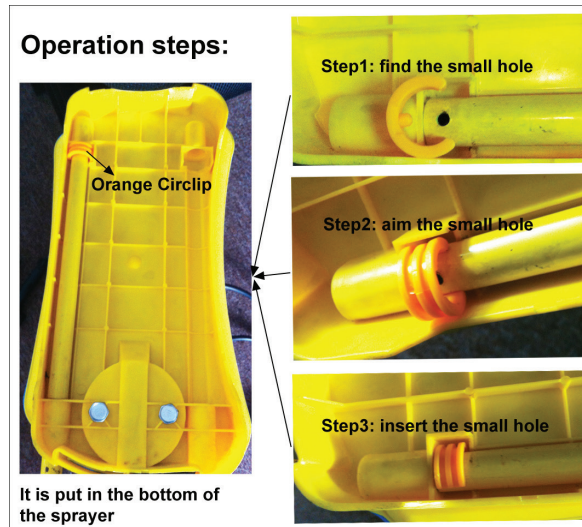

#22 on Spare Parts Diagram

## 20L Backpack Sprayer 20L\_BPS

### Spare Part Explanation

